



State of New Jersey
Department of Environmental Protection
 Division of Land Use Regulation
 Application Form for Permit(s)/Authorization(s)
 501 E. State Street Mail Code 501-02A P.O. Box 420
 Trenton, NJ 08625-0420
 Phone #: (609) 777-0454 Web: www.nj.gov/dep/landuse



JA

Please print legibly or type the following: Complete all sections and pages unless otherwise noted. Is this project Superstorm Sandy Related Yes No

1. **Applicant Name:** Mr./Ms./Mrs Jaylin Holdings, LLC c/o Grunin Properties E-Mail: grunin1@verizon.net
Address: Dover Esplanade Building, 1027 Hooper Avenue Daytime Phone: 732-341-5800 Ext. _____
City/State: Toms River, NJ Zip Code 08753 Cell Phone: _____

2. **Agent Name:** Mr./Ms./Mrs William F. Harrison, Esq.
Firm Name: Genova Burns LLC E-Mail: wharrison@genovaburns.com
Address: 494 Broad Street Daytime Phone: _____ Ext. _____
City/State: West Orange, NJ Zip Code 07102 Cell Phone: _____

3. **Property Owner:** Mr./Ms./Mrs Jaylin Holdings, LLC c/o Grunin Properties E-mail: grunin1@verizon.net
Address: Dover Esplanade Building, 1027 Hooper Avenue Daytime Phone: 732-341-5800 Ext. _____
City/State: Toms River, NJ Zip Code 08753 Cell Phone: _____

4. **Project Name:** Proposed Retail Development Address/Location: _____
Municipality: Toms River / Manchester County: Ocean Zip Code _____
Block(s): 505 / 44 and 75.01 Lot(s): 14 & 15 / 2, 3, 4, 5, 9 and 3
 N.A.D. 1983 State Plane Coordinates (feet) E (x): 555,392 N(y): 421,711 *Not Longitude/Latitude*
Watershed: Toms River (below Oak Ridge Parkway) Subwatershed: Wrangel Brook (below Michaels Branch)
Nearest Waterway: Ambrose Brook

5. **Project Description:** Construct one 115,532-SF retail building, three 4,800-SF restaurants and one 9,322-SF retail building and associated parking, circulation, utilities, stormwater management, landscaping and lighting associated with these uses.

Provide if applicable: Previous LUR File # (s): _____ Waiver request ID # (s): _____

A. SIGNATURE OF APPLICANT (required):

I certify under penalty of law that I have personally examined and am familiar with the information submitted in this document and all attachments and that, based on my inquiry of those individuals immediately responsible for obtaining and preparing the information, I believe that the information is true, accurate, and complete. I am aware that there are significant penalties for knowingly submitting false information, including the possibility of fine and imprisonment. If the applicant is an organization such as a corporation, municipal entity, home-owners association etc., the party responsible for the application shall sign on behalf of the organization.

x JAY A. GRUNIN
 Signature of Applicant
2/16/18
 Date
JAY A. GRUNIN
 Print Name

 Signature of Applicant
FEB 23 '18 4:11:00
 LAND USE REGULATION

 Date

 Print Name

B. PROPERTY OWNER'S CERTIFICATION

I hereby certify that the undersigned is the owner of the property upon which the proposed work is to be done. This endorsement is certification that the owner/easement holder grants permission for the conduct of the proposed activity. In addition, written consent is hereby given to allow access to the site by representatives or agents of the Department for the purpose of conducting a site inspection(s) or survey(s) of the property in question.

In addition, the undersigned property owner hereby certifies:

- 1. Whether any work is to be done within an easement? Yes No

(If answer is "Yes" – Signature/title of responsible party is required below)
- 2. Whether any part of the entire project will be located within property belonging to the State of New Jersey? Yes No
- 3. Whether any work is to be done on any property owned by any public agency that would be encumbered by Green Acres? Yes No
- 4. Whether this project requires a Section 106 (National Register of Historic Places) Determination as part of a federal approval? Yes No

x JAY A. GRUNIN
 Signature of Owner
3/16/18
 Date
JAY A. GRUNIN
 Print Name

 Signature of Owner/Easement Holder

 Date

 Print Name/Title

C. APPLICANT'S AGENT

I JAY A. GRUNIN, the Applicant/Owner and _____, co-Applicant/Owner authorize to act as my agent/representative in all matters pertaining to my application the following person:

William F. Harrison
 Name of Agent

 Occupation/Profession of Agent

x JAY A. GRUNIN
 Signature of Applicant/Owner

 Signature of co-Applicant/Owner

AGENT'S CERTIFICATION:

I agree to serve as agent for the above-referenced applicant:

Signature of Agent

NOTARY:

Sworn to me, this day of: _____, 20____

Notary Public

D. STATEMENT OF PREPARER OF PLANS, SPECIFICATIONS, SURVEYOR'S OR ENGINEER'S REPORT

I certify under penalty of law that I have personally examined and am familiar with the information submitted in this document and all attachments and that, based on my inquiry of those individuals immediately responsible for obtaining and preparing the information, I believe that the information is true, accurate, and complete. I am aware that there are significant penalties for knowingly submitting false information, including the possibility of fine and imprisonment.

Signature

Print Name

Position & Name of Firm

Professional License # Date

E. STATEMENT OF PREPARER OF APPLICATION, REPORTS AND/OR SUPPORTING DOCUMENTS (other than engineering)

I certify under penalty of law that I have personally examined and am familiar with the information submitted in this document and all attachments and that, based on my inquiry of those individuals immediately responsible for obtaining and preparing the information, I believe that the information is true, accurate, and complete. I am aware that there are significant penalties for knowingly submitting false information, including the possibility of fine and imprisonment.

Signature

Print Name

Position & Name of Firm

Professional License # Date
 (if Applicable)

F. APPLICATION(S) FOR: (Check all that apply – Fee calculations and directions on pages 6, 7, & 8)

	Coastal General Permits	Fee Amount	Fee Paid
<input type="checkbox"/>	CZMGP1 Amusement Pier Expansion	\$1,000.00	
<input type="checkbox"/>	CZMGP2 Beach/Dune Activities	\$1,000.00	
<input type="checkbox"/>	CZMGP3 Voluntary Reconstruction Certain Residential/Commercial Dev.	\$1,000.00	
<input type="checkbox"/>	CZMGP4 Development of one or two SFH or Duplexes	\$1,000.00	
<input type="checkbox"/>	CZMGP5 Expansion or Reconstruction SFH/Duplex	\$1,000.00	
<input type="checkbox"/>	CZMGP6 New Bulkhead/Fill Lagoon	\$1,000.00	
<input type="checkbox"/>	CZMGP7 Revetment at SFH/Duplex	\$1,000.00	
<input type="checkbox"/>	CZMGP8 Gabions at SFH/Duplex	\$1,000.00	
<input type="checkbox"/>	CZMGP9 Support Facilities at a Marina	\$1,000.00	
<input type="checkbox"/>	CZMGP10 Reconstruction of Existing Bulkhead	\$1,000.00	
<input type="checkbox"/>	CZMGP11 Hazard Waste Clean-up	\$1,000.00	
<input type="checkbox"/>	CZMGP12 Landfall of Utilities	\$1,000.00	
<input type="checkbox"/>	CZMGP13 Recreation Facility at Public Park	\$1,000.00	
<input type="checkbox"/>	CZMGP14 Bulkhead Construction & Fill Placement	\$1,000.00	
<input type="checkbox"/>	CZMGP15 Construction of Piers/Docks/Ramps in Lagoons	\$1,000.00	
<input type="checkbox"/>	CZMGP16 Minor Maintenance Dredging in Lagoons	\$1,000.00	
<input type="checkbox"/>	CZMGP17 Eroded Shoreline Stabilization	\$1,000.00	
<input type="checkbox"/>	CZMGP18 Avian Nesting Structures	\$1,000.00	
<input type="checkbox"/>	CZMGP19 Modification of Electrical Substations	\$1,000.00	
<input type="checkbox"/>	CZMGP20 Legalization of the Filling of Tidelands	\$1,000.00	
<input type="checkbox"/>	CZMGP21 Construction of Telecommunication Towers	\$1,000.00	
<input type="checkbox"/>	CZMGP22 Construction of Tourism Structures	\$1,000.00	
<input type="checkbox"/>	CZMGP23 Geotechnical Survey Borings	\$1,000.00	
<input type="checkbox"/>	CZMGP24 Habitat Creation/Restoration/Enhancement/Living Shorelines	No Fee	No Fee
<input type="checkbox"/>	CZMGP25 1 to 3 Turbines < 200 Feet	\$1,000.00	
<input type="checkbox"/>	CZMGP26 Wind Turbines < 250 Feet	\$1,000.00	
<input type="checkbox"/>	CZMGP27 Dredge Lagoon (post storm event)	\$1,000.00	
<input type="checkbox"/>	CZMGP28 Dredge post Bulkhead Failure	\$1,000.00	
<input type="checkbox"/>	CZMGP29 Dredge Marina (post storm event)	\$1,000.00	
<input type="checkbox"/>	CZMGP30 Aquaculture Activities	\$1,000.00	
<input type="checkbox"/>	CZMGP31 Placement of Shell (shellfish areas)	\$1,000.00	
<input type="checkbox"/>	CZMGP32 Application of Pesticides in Coastal Wetlands	\$1,000.00	
<input type="checkbox"/>	CZM General Permit Extension	\$240.00	
<input type="checkbox"/>	CZM Permit-by-Certification (On-line application ONLY)	\$600.00	

	Flood Hazard Area General Permits	Fee Amount	Fee Paid
<input type="checkbox"/>	FHAGP1 Channel Clean w/o Sediment Removal	No Fee	No Fee
<input type="checkbox"/>	FHAGP1 Channel Clean w/Sediment Removal	No Fee	No Fee
<input type="checkbox"/>	FHAGP2 Mosquito Control	\$1,000.00	
<input type="checkbox"/>	FHAGP3 Scour Protection Bridges/Culverts	\$1,000.00	
<input type="checkbox"/>	FHAGP4 Creation/Restoration/Enhancement of Habitat and Water Quality Values and Functions	No Fee	No Fee
<input type="checkbox"/>	FHAGP5 Reconstruction and/or Elevation of Building in a Floodway	No Fee	No Fee
<input type="checkbox"/>	FHAGP6 Construction of One SFH/Duplex and Driveway	\$1,000.00	
<input type="checkbox"/>	FHAGP7 Relocation of Manmade Roadside Ditches for Public Roadway Improvements	\$1,000.00	
<input type="checkbox"/>	FHAGP8 Placement of Storage Tanks	\$1,000.00	
<input type="checkbox"/>	FHAGP9 Construction/Reconstruction of Bridge/Culvert Across Water < 50 Acres	\$1,000.00	
<input type="checkbox"/>	FHAGP10 Construction/Reconstruction of Bridge/Culvert Across Water > 50 Acres	\$1,000.00	
<input type="checkbox"/>	FHAGP11 Stormwater Outfall Along Regulated Water <50 Acres	\$1,000.00	
<input type="checkbox"/>	FHAGP12 Construction of Footbridges	\$1,000.00	
<input type="checkbox"/>	FHAGP13 Construction of Trails and Boardwalks	\$1,000.00	
<input type="checkbox"/>	FHA General Permit Extension	\$240.00	
<input type="checkbox"/>	FHA Permit-by-Certification (Except PBC 4 & 5) (On-line application ONLY)	\$1,000.00	

	Flood Hazard Area	Fee Amount	Fee Paid
<input type="checkbox"/>	FHA Verification		
<input type="checkbox"/>	FHA Individual Permit		
<input type="checkbox"/>	FHA Hardship Exception (Must be submitted with a paid FHA IP)	\$4,000.00	
<input type="checkbox"/>	FHA Minor Technical Modification of a GP, IP or Verification		
<input type="checkbox"/>	FHA Major Technical Modification of a GP, IP or Verification		
<input type="checkbox"/>	FHA Extension of an IP or Verification		
<input type="checkbox"/>	FHA Individual Permit Equivalency/CERCLA	No Fee	No Fee

	Stormwater Review Fees	Fee Amount	Fee Paid
<input type="checkbox"/>	Fee for all Stormwater Reviews		

	Applicability Determination	Fee Amount	Fee Paid
<input type="checkbox"/>	Coastal Applicability Determination	No Fee	No Fee
<input type="checkbox"/>	Flood Hazard Applicability Determination	No Fee	No Fee
<input type="checkbox"/>	Highlands Jurisdictional Determination	No Fee	No Fee
<input type="checkbox"/>	Executive Order 215	No Fee	No Fee

	CAFRA and Waterfront Development Permits	Fee Amount	Fee Paid
X	CAFRA Individual Permit	\$30,000	\$30,000
<input type="checkbox"/>	CAFRA Exemption Request	\$500.00	
<input type="checkbox"/>	Waterfront Development Individual Permit/Upland		
<input type="checkbox"/>	Waterfront Development Individual Permit/In-water		
<input type="checkbox"/>	Minor Technical Modification of a Coastal GP or Coastal IP		
<input type="checkbox"/>	Major Technical Modification of a Coastal GP or Coastal IP		
<input type="checkbox"/>	Zane Letter	\$500.00	
<input type="checkbox"/>	Waterfront Development Individual Permit - Extension		
<input type="checkbox"/>	Individual Permit Equivalency/CERCLA	No Fee	No Fee

	Highlands	Fee Amount	Fee Paid
<input type="checkbox"/>	Emergency Permit		
<input type="checkbox"/>	Pre-application Meeting	\$500.00	
<input type="checkbox"/>	Resource Area Determination >one acre		
<input type="checkbox"/>	HPAAGP 1/ Habitat Creation/Enhance	No Fee	No Fee
<input type="checkbox"/>	HPAAGP 2 Bank Stabilization	\$500.00	
<input type="checkbox"/>	Preservation Area Approval (PAA)		
<input type="checkbox"/>	PAA with Waiver (Specify type below)		

	Coastal Wetlands	Fee Amount	Fee Paid
<input type="checkbox"/>	Coastal/Tidal Wetlands Permit		
<input type="checkbox"/>	Coastal Wetland Permit Modification		

	Freshwater Wetlands	Fee Amount	Fee Paid
<input type="checkbox"/>	FWGP1 Main. & repair Exist Feature	\$1,000.00	
<input type="checkbox"/>	FWGP2 Utility Crossing	\$1,000.00	
<input type="checkbox"/>	FWGP3 Discharge of Return Water	\$1,000.00	
<input type="checkbox"/>	FWGP4 Hazard Site Invest/Cleanup	\$1,000.00	
<input type="checkbox"/>	FWGP5 Landfill Closure	\$1,000.00	
<input type="checkbox"/>	FWGP6 Filling of NSWC	\$1,000.00	
<input type="checkbox"/>	FWGP6/ATA- Filling of NSWC	\$1,000.00	
<input type="checkbox"/>	FWGP7 Fill ditch / swale	\$1,000.00	
<input type="checkbox"/>	FWGP8 House Addition	\$1,000.00	
<input type="checkbox"/>	FWGP9 Airport Sightline Clearing	\$1,000.00	
<input type="checkbox"/>	FWGP10A Very Minor Road Crossing	\$1,000.00	
<input type="checkbox"/>	FWGP10B Minor Road Crossing	\$1,000.00	
<input type="checkbox"/>	FWGP11 Outfalls / Intakes	\$1,000.00	
<input type="checkbox"/>	FWGP12 Survey / Investigation	\$1,000.00	
<input type="checkbox"/>	FWGP13 Lake Dredging	\$1,000.00	
<input type="checkbox"/>	FWGP14 Water Monitoring	\$1,000.00	
<input type="checkbox"/>	FWGP15 Mosquito Control	\$1,000.00	
<input type="checkbox"/>	FWGP16 Habitat Create / Enhance	No Fee	No Fee
<input type="checkbox"/>	FWGP17 Trails / Boardwalks	\$1,000.00	
<input type="checkbox"/>	FWGP17A Multiuse paths	\$1,000.00	
<input type="checkbox"/>	FWGP18 Dam Repairs	\$1,000.00	
<input type="checkbox"/>	FWGP19 Dock or Pier	\$1,000.00	
<input type="checkbox"/>	FWGP20 Bank Stabilization	\$1,000.00	
<input type="checkbox"/>	FWGP21 Above Ground Utility	\$1,000.00	
<input type="checkbox"/>	FWGP23 Expand Cranberry	No Fee	No Fee
<input type="checkbox"/>	FWGP24 Spring Developments	\$1,000.00	
<input type="checkbox"/>	FWGP25 Malfunction Septic System	No Fee	No Fee
<input type="checkbox"/>	FWGP26 Channel / Stream Clean	\$1,000.00	
<input type="checkbox"/>	FWGP27 Redevelop Disturbed Site	\$1,000.00	
<input type="checkbox"/>	FWGP Modification	\$500.00	
<input type="checkbox"/>	FWGP Extension	\$500.00	

	Freshwater Wetlands	Fee Amount	Fee Paid
<input type="checkbox"/>	Individual Wetlands Permit		
<input type="checkbox"/>	Individual Open Water Permit		
<input type="checkbox"/>	Individual Permit Mod. Major/Minor		
<input type="checkbox"/>	Individual Permit Extension		
<input type="checkbox"/>	Wetlands Exemption	\$500.00	
<input type="checkbox"/>	Permit Equivalency/CERCLA	No Fee	No Fee

	Transition Area Waiver	Fee Amount	Fee Paid
X	Averaging Plan	\$1,200	\$1,200
<input type="checkbox"/>	Reduction		
<input type="checkbox"/>	Hardship Reduction		
<input type="checkbox"/>	Special Activity Stormwater		
<input type="checkbox"/>	Special Activity Linear Development		
<input type="checkbox"/>	Special Activity Redevelopment		
<input type="checkbox"/>	Special Activity Individual Permit		
<input type="checkbox"/>	Exemption	\$500.00	
<input type="checkbox"/>	Modification Major/Minor		
<input type="checkbox"/>	Extension	\$500.00	

	Letter of Interpretation	Fee Amount	Fee Paid
<input type="checkbox"/>	Presence Absence	\$1,000.00	
<input type="checkbox"/>	Presence Absence Footprint	\$1,000.00	
<input type="checkbox"/>	Delineation < 1.00 Acres	\$1,000.00	
<input type="checkbox"/>	Verification		
<input type="checkbox"/>	Extension		

	Consistency Determination	Fee Amount	Fee Paid
<input type="checkbox"/>	Water Quality Certificate		
<input type="checkbox"/>	Federal Consistency	No Fee	No Fee
<input type="checkbox"/>	HMC Water Quality Certificate		

Please note:

If no fee amount is specified in the "Fee Amount" column, please refer to the Regulatory Fee Schedule which can be found at www.nj.gov/dep/landuse/forms.html. The following types of applications DO NOT require a fee submittal:

Coastal Permitting

- General Permit # 24 - Habitat creation, restoration, enhancement and living shoreline activities
- Individual Permit Equivalency - CERCLA
- Administrative Modifications

Applicability Determinations

- Coastal Applicability Determination
- Highlands Jurisdictional Determination
- Flood Hazard Area Applicability
- Executive Order 215

Flood Hazard Area

- General Permit #1 - Channel cleaning under the Stream Cleaning Act
- General Permit #4 - Creation, restoration, and enhancement of habitat and water quality values and functions
- General Permit #5 - Reconstruction and/or elevation of a building in a floodway
- Transfer of Approval
- Administrative Modifications
- Individual Permit Equivalency - CERCLA

Federal Consistency

- Federal Consistency Determination

Highlands

- General Permit #1 - Habitat Creation, Restoration, Enhancement

Freshwater Wetlands

- General Permit #16 - Habitat creation and enhancement activities
- General Permit #17 - Trails and Boardwalks (NO FEE when the activity is proposed on publicly owned lands)
- General Permit #23 - Expansion of cranberry growing operations in the Pinelands
- General Permit #25 - Malfunctioning individual subsurface sewage disposal (septic) systems
- Individual Permit Equivalency - CERCLA

Also:

In addition to the standard paper submission, an electronic copy of the entire application, including plans, may be submitted on CD-ROM to assist the Department in the review this application. Plans should be submitted as a CAD file or Shapefile, georeferenced in NJ state plane feet NAD83. Please do **NOT** send the electronic version via E-Mail.

Electronic permitting and/or application submittal is available for specific applications. Please see the Division website at www.nj.gov/dep/landuse/epermit.html for more information.

APPLICANT NAME: JAYLIN HOLDINGS, LLC C/O
GRUNIN
PROPERTIES

FILE # (if known): 1500-04-0001.1

APPLICATION FORM - APPENDIX I

Section 1: Please provide the following information for the overall project site. All area measurements shall be recorded in acres to the nearest thousandth (0.001 acres).

<u>PROPOSED:</u>	<u>PRESERVED</u>	<u>UNDISTURBED</u>	<u>DISTURBED</u>
RIPARIAN ZONE	_____	_____	_____
CZMRA FORESTED (CZMRA IP - Only)	_____	_____	_____
E & T HABITAT Endangered and/or Threatened	_____	_____	_____
FRESHWATER WETLANDS	_____	_____	_____

Section 2: Please provide the following information for each permit/authorization requested pursuant to the Freshwater Wetlands Protection Act. All area measurements shall be recorded in acres to the nearest thousandth (0.001 acres). Use additional sheets if necessary

PERMIT TYPE	WETLAND TYPE <i>Emergent, Forest, Shrub, Etc.</i>	RESOURCE CLASSIFICATION <i>Ordinary, Intermediate, Exceptional, EPA, Etc.</i>
<u>PROPOSED DISTURBANCE:</u>	<u>WETLANDS</u>	<u>TRANSITION AREA</u>
FILLED	_____	_____
EXCAVATED	_____	_____
CLEARED	_____	_____
TEMPORARY DISTURBANCE	_____	_____

PERMIT TYPE	WETLAND TYPE <i>Emergent, Forest, Shrub, Etc.</i>	RESOURCE CLASSIFICATION <i>Ordinary, Intermediate, Exceptional, EPA, Etc.</i>
<u>PROPOSED DISTURBANCE:</u>	<u>WETLANDS</u>	<u>TRANSITION AREA</u>
FILLED	_____	_____
EXCAVATED	_____	_____
CLEARED	_____	_____
TEMPORARY DISTURBANCE	_____	_____

Appendix II - Fee Calculation Sheet (Required)

Directions:

The Fee Calculation sheet is broken down by the types of programs administered by the Division of Land Use Regulation: Coastal, Flood Hazard Area, Freshwater Wetlands, Stormwater Review.

Use the abbreviation key below in order to identify the type(s) of applications that you need to submit for your project. Once you find your application type(s) work through the **calculation column** and place the figure on the fee amount line. Do this for each application type and subtotal each section. In section 5 – enter the subtotals as indicated and add the fee figures to find your total fee.

- Whenever the calculation requires an acreage figure, you will need to round UP to the nearest whole number, for example: 0.25 acres gets rounded up to one (1) acre or 2.61 acres gets rounded up to three (3) acres.
- The maximum fee for a CAFRA Individual permit, an Upland Waterfront Development permit, or an In-Water Waterfront Development permit is \$30,000 per permit type. For example: if you are applying for both an upland and an in-water Waterfront Development the maximum fee is applied to each permit for a maximum total of \$60,000 plus any applicable stormwater review fee.
- No matter how many types of applications are required, the stormwater review fee is applied only one time.

Abbreviation KEY

CAFRA = CZM	General Permit = GP	Single Family Home = SFH
Coastal (Tidal) Wetlands = CSW	Individual Permit = IP	Transition Area Waiver = TAW
Extension = EXT	Letter of Interpretation = LOI	Verification = VER
Flood Hazard Area = FHA	Mean High Water Line = MHWL	Waterfront Development = WD
Freshwater Wetlands = FWW	Modification = MOD	Water Quality Certificate = WQC

Section 1 - Coastal Application Type

Calculation

Fee Amount

All General Permits (Except for Coastal GP #4)	\$1,000 x # of GPs requested	
CZM – IP SFH or Duplex	\$2,000	
CZM – IP Residential other than SFH/duplex	\$3,000 x # of units	
CZM – IP Commercial, Industrial or Public	\$3,000 x 73 acres of the site	\$30,000
CSW – IP SFH or Duplex	\$2,000	
CSW – IP All Development other than SFH/duplex	\$3,000 x acres of wetlands disturbed	
WD – IP SFH or Duplex (Landward of MHWL)	\$2,000	
WD – IP Residential other than SFH/duplex (Landward of MHWL)	\$3,000 x # of units	
WD – IP Commercial, Industrial or Public Development	\$3,000 x acres of the site	
WD – IP SFH or Duplex (Waterward of MHWL)	\$2,000	
WD – IP All Development other than SFH/duplex (Waterward of MHWL)	\$3,000 x acres of water area impacted	
CZM, CSW, WD – Minor Technical Modification (GP/IP)	\$500 x # of items to be revised	
CZM, CSW, WD – Major Technical Modification (GP/IP)	0.30 x original fee = Fee (Minimum \$500)	
General Permit Extension	\$240 x # of GPs to be extended	
WD – IP Permit Extension	0.25 x original fee = Fee (Maximum \$3,000)	
CZM, CSW, WD – Exemption Request	\$500 x # of exemptions requested	

\$30,000

Subtotal for Coastal Applications

Section 2 - Freshwater Wetlands Application Type

Calculation

Fee Amount

All General Permits (Except those listed in notes on Page 4)	\$1,000 x # of GPs requested	
FWW – LOI Presence/Absence, Footprint, Delineation < 1 acre	\$1,000	
FWW – LOI Line Verification	\$1,000 + (\$100 x # of acres of the site)	
FWW – TAW with valid LOI	\$1,000 + (\$100 x 1.122 # acres FWW disturbed)	\$1,200
FWW – TAW without valid LOI	\$1000 + (\$100 x acres TAW disturbed) + LOI Fee	
FWW – IP or Open Water Fill SFH or Duplex	\$2,000	
FWW – IP or Open Water Fill other than SFH or Duplex	\$5,000 + (\$2,500 x # acres FWW disturbed)	
FWW – GP, TAW, IP, Open Water Fill Minor Modification	\$500 x # of items to be revised	
FWW – GP, TAW, IP, Open Water Fill Major Modification	0.30 x original fee (Minimum \$500)	
FWW – EXT LOI Presence/Absence, Footprint, Delineation < 1 acre	\$500	
FWW – EXT LOI Line Verification	0.50 x original fee (Minimum \$500)	
FWW – EXT GP or TAW	\$500 x # of items to be extended	
FWW – EXT IP or Open Water Fill	0.50 x original fee (Minimum \$500)	

\$1,200

Subtotal for Freshwater Wetlands Applications

Appendix II - Fee Calculation Sheet - Continued

<u>Section 3 - Flood Hazard Area Application Type</u>	<u>Calculation</u>	<u>Fee Amount</u>
All General Permits (Except for FHAGP 1, 4, 5)	\$1,000 x # of GPs requested	
FHA – VER Methods 1, 2, 3, 5 (Fee not applicable to one (1) SFH)	\$1,000	
FHA – VER Method 4 or 6	\$4,000 + (\$400 x _____ per 100 linear feet)	
FHA – Delineation of Riparian Zone Only	\$1,000	
FHA – IP SFH and/or Accessory Structures	\$2,000	
FHA – IP * Fee not applicable to one (1) SFH	\$3,000 base	
*Bank/Channel (stabilization, reestablishment, etc.) No Calculation Review --	+ \$1,000	
*Bank/Channel (stabilization, reestablishment, etc.) With Calculation Review--	+ (\$4,000 + (\$400 x _____ per 100 linear ft.))	
*Bridge, Culvert, Footbridge, Low Dam, etc. No Calculation Review--	+ \$1,000 x _____ # of structures	
*Bridge, Culvert, Footbridge, Low Dam, etc. With Calculation Review--	+ \$4,000 x _____ # of structures	
*Review of Flood Storage Displacement (net fill) Calculations-----	+ \$4,000	
Review of Hardship Exception Request-----	+ \$4,000	
*Utility Line-----	+ \$1,000 x _____ # of water crossings	
FHA – VER, IP, GP Minor Technical Modification	\$500 x _____ # of project elements to be revised	
FHA – VER, IP, GP Major Technical Modification	0.30 x _____ original fee (Minimum \$500)	
FHA – Extension of Verification - Method 1, 2, 3, 5, Riparian Zone	\$240.00	
FHA - Extension of Verification - Method 4 or 6	0.25 x _____ original fee	
FHA – Extension of a General Permit	\$240.00 x _____ # of GPs to be extended	
FHA – Extension of an Individual Permit	0.25 x _____ original fee	
FHA – Department Delineation Minor Revision	\$500	
FHA – Department Delineation Major Revision	\$4,000 + (\$400 x _____ per 100 linear feet)	

Subtotal for Flood Hazard Area Applications _____

<u>Section 4 – Individual Water Quality Certificate</u>	<u>Calculation</u>	<u>Fee Amount</u>
WQC (NOTE: No fee required under the coastal program)	\$5,000 + (\$2,500 x _____ # acres regulated area disturbed)	

<u>Section 5 - Additional Stormwater Review Fee</u>	<u>Calculation</u>	<u>Fee Amount</u>
Stormwater Review	\$3,000 base	
Review of Groundwater Recharge Calculations-----	+ \$250 x _____ # acres disturbed	
Review of Runoff Quantity Calculations-----	+ \$250 x _____ # acres disturbed	
Review of Water Quality Calculations-----	+ \$250 x _____ # acres impervious surface	

Subtotal of Stormwater Review Fee _____
Previously paid

<u>Section 6 - Total of Application Fees</u>	
Subtotal of Section 1 - Coastal Applications	\$30,000
Subtotal of Section 2 - Freshwater Wetlands Applications	\$1,200
Subtotal of Section 3 - Flood Hazard Area Applications	
Subtotal of Section 4 – Individual Water Quality Certificate	
Subtotal of Section 5 - Additional Stormwater Review	
Total Application Fee	\$31,200

Handwritten calculation:
 3,000
 13,500
 2,750

 \$19,250
 Stormwater
 Fee

Total Fee: \$31,200

Check #: _____

Instructions for completing the Application Form for Permits/Authorizations from the Division of Land Use Regulation
(Please print clearly or type all information in every section)

Section 1. Applicant Information

- ✓ Please check off whether the project is Superstorm Sandy related.
- ✓ Make sure all applicant information is correct and up to date.
- ✓ Do not provide telephone numbers with call intercept.
- ✓ Must include correct E-mail address.

Section 2. Agent Information

- ✓ Make sure all agent information is correct and up to date.
- ✓ Do not provide telephone numbers with call intercept.
- ✓ If you do not have an agent, leave this section blank.
- ✓ Must include correct E-mail address.

Section 3. Property Owner Information

- ✓ Identify the property owner if different from applicant.

Section 4. Project Site Information/Fees and Costs

- ✓ List the street address if known (or nearest crossroads) along with the correct zip code for the property.
- ✓ List all blocks and lots if more space is needed please attach a list to the application form.
- ✓ Make sure the state plane coordinates are given and that they are 1983 datum otherwise the application will be rejected.
 - Applicants can find state plane coordinates on USGS maps or by going to the NJDEP website and using the GeoWeb feature to find the location of property and the exact state plane coordinates

Section 5. Project Description

- ✓ Briefly describe what you are proposing to construct within regulated areas. In addition, list any previous LUR file number(s) and if a Waiver Request has been submitted to the Office of Permit Coordination and Environmental Review please list the Waiver Request ID number(s) on the line provided.

Section A. Applicant's Signature

- ✓ The person or responsible party representative applying for this permit and to whom the permit will be issued must sign here.

Section B. Property Owner's Signature

- ✓ The legal owner of the property on which the regulated activities are proposed must sign here and certify items one through four in this section. In addition, all easement owners on the project site are also required to sign the certification.

Section C. Applicant's Agent Authorization

- ✓ If the applicant is represented by a consultant or engineer, that individual shall fill out this section.

Section D. Statement of the Preparer of Plans, Specifications, Surveyor's or Engineer's Report

- ✓ All Flood Hazard Area and Waterfront Development applications require that the person preparing the plans and reports fill out this section

Section E. Statement of the Preparer of Application, Reports and Supporting Documents

- ✓ Anyone who prepares and is the responsible person for part of the application, reports or supporting documents must fill out this section

Section F. Type of Application you are submitting

- ✓ Place a check mark next to each type of activity you are requesting in this application package. Please fill in the amount of fee required for each permit and the amount of fees paid for each permit. The fee paid may be different from the amount required for each permit since the amount required may differ due the three payment plan for fees in excess of \$1,000. A Fee Calculation Sheet is now included to allow an applicant to determine the fee for applications where the fee will vary due to size of site, impacts, etc.

Appendices Please follow the directions as outlined for each Appendix.

- ✓ Both Appendix I and II are required to be filled-out and submitted in order for the application form to be considered completed

Please Note: The following permits and authorizations are available as on-line applications at <http://www.nj.gov/dep/landuse> under "Electronic Services":

Coastal General Permits-by-Certification #10 and #15

Flood Hazard Area Permits-by-Certification #1 thru #15

Freshwater Wetlands General Permits #8 and #25

Freshwater Wetlands E-LOI (submittal only)

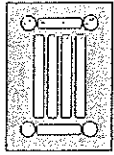

**GENOVA
BURNS**
ATTORNEYS-AT-LAW

Genova Burns LLC
494 Broad Street, Newark, NJ 07102
Tel: 973.533.0777 Fax: 973.533.1112
Web: www.genovaburns.com

William F. Harrison, Esq.
Partner
Member of NJ Bar
wharrison@genovaburns.com
Direct: 973-535-4430

February 22, 2018

VIA UPS GROUND

NJ Department of Environmental Protection
Division of Land Use Regulation
501 East State Street
Station Plaza 5, 2nd Floor
Trenton, New Jersey 08609

FEB 23 '18 AM 11:00
LAND USE REGULATI

Attn.: Eric Virostek, Application Support

**Re: Application for CAFRA Individual Permit
Application for Transition Area Waiver: Averaging Plan Transition Area
Waiver**
**Property: Block 505 lots 14 and 15
Township of Toms River
Block 44, Lots 2, 3, 4, 5 and 9
Block 75.01, Lot 3
Township of Manchester**
Applicant: Jaylin Holdings, LLC

Dear Mr. Virostek

Applicant is submitting the above-referenced application for a Coastal Area Facility Review Act ("CAFRA") Individual Permit and a Transition Area Waiver, specifically an averaging plan transition area waiver, to construct one 111,186 square foot retail building, three 4,800 square foot restaurants and one 9,322 square foot retail building, and includes associated parking, circulation, utilities, stormwater management, landscaping and lighting associated with these uses. Five hundred and sixty-seven (567) parking spaces are proposed for the entire development. A stormwater management system that utilizes three above-ground basins has also been designed to accommodate this development.

Please accept the following as submission of the remaining application items, thereby completing the application in accordance with the submission requirements:

- *Land Use Application Form* executed by Applicant and Agent;
- *Land Use Application Form* executed by preparer of plans;



NJ Department of Environmental Protection

February 22, 2018

Page 2

- *One (1) check representing the required Application Fee; and*
- *Proof of Notices.*

Very truly yours,

GENOVA BURNS LLC

William F. Harrison
WILLIAM F. HARRISON

WFH/KEB
Enclosures

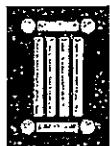

**GENOVA
BURNS**
ATTORNEYS-AT-LAW

Genova Burns LLC
494 Broad Street, Newark, NJ 07102
Tel: 973.533.0777 Fax: 973.533.1112
Web: www.genovaburns.com

William F. Harrison, Esq.
Partner
Member of NJ Bar
wharrison@genovaburns.com
Direct: 973-535-4430

January 25, 2018

VIA CERTIFIED MAIL

Alison Carlisle, Township Clerk
Township of Toms River
33 Washington Street
Toms River, New Jersey 08754-0728

Re: Application for CAFRA Individual Permit
 Application for Transition Area Waiver
 Proposed Retail Development
Township of Toms River: Block 505, Lots 14 and 15
Township of Manchester: Block 44, Lots 2, 3, 4, 5 and 9;
 Block 75.01, Lot 3

Ocean County
DEP File No. 1500-04-0001.3-CAF160001

Dear Ms. Carlisle:

This letter is to provide you with legal notification that an individual CAFRA permit application and transition area waiver application will be submitted to the New Jersey Department of Environmental Protection, Division of Land Use Regulation for the development shown on the enclosed plan. A complete copy of the CAFRA application and Transition Area Waiver application is enclosed and includes the following:

- *CAFRA Individual Permit Application* prepared by Bohler Engineering, dated December 2017;
- *Barred Owl* letter prepared by EcolSciences, Inc. dated January 12, 2018;
- *Freshwater Wetland Transition Area Waiver Averaging Plan* prepared by Bohler Engineering, dated December 2017;
- *Stormwater Management Facility Operations and Maintenance Manual* prepared by Bohler Engineering, dated November 2017;



Ms. Alison Carlisle, Township Clerk
Township of Toms River
January 25, 2018
Page 2

- *Stormwater Management Report* prepared by Bohler Engineering, dated November 2017;
- *Boundary & Wetland Location Survey*, prepared by Control Point Associates, Inc., dated August 6, 2015, last revised November 20, 2017;
- *ALTA/ASCM Land Title Survey*, prepared by Control Point Associates, Inc., dated April 21, 2004, last revised November 29, 2017;
- *Preliminary & Final Site Plan for Grunin Properties*, dated November 30, 2017; and,
- Compact Disc containing the contents of the previous submission, Permit No. 1500-04-001.1, APL080001, SWW090001.

A brief description of the proposed development follows:

The proposed development includes one (1) 111,186-SF retail building, three (3) 4,800-SF restaurants and one (1) 9,322-SF retail building. Also included is the associated parking, circulation, utilities, stormwater management; landscaping and lighting associated with these uses. Five hundred and sixty-seven (567) parking spaces are proposed for the entire development. A stormwater management system that utilizes three above-ground basins has been designed to accommodate the development.

The Department of Environmental Protection welcomes comments and any information that you may provide concerning the proposed development and site. Please submit your written comments within 15 calendar days of receiving this letter to:

New Jersey Department of Environmental Protection
Division of Land Use Regulation
P.O. Box 420 , Code 501-02A
Trenton, New Jersey 08625
Attn: Toms River Bureau Chief or
Manchester Bureau Chief

Enclosed is a check for \$50.00 payable to the Township of Toms River for the CAFRA storage filing fee.



GENOVA
BURNS
ATTORNEYS-AT-LAW

Ms. Alison Carlisle, Township Clerk
Township of Toms River
January 25, 2018
Page 3

If you have any questions regarding this notice, please feel free to contact me.

Very truly yours,

GENOVA BURNS LLC

William F. Harrison
WILLIAM F. HARRISON

WFH
Enclosures

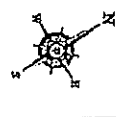

TRANSPORTATION DEPARTMENT

	Proposed Right-of-Way
	Proposed Roadway
	Proposed Roadway
	Proposed Roadway
	Proposed Roadway
	Proposed Roadway
	Proposed Roadway
	Proposed Roadway
	Proposed Roadway
	Proposed Roadway

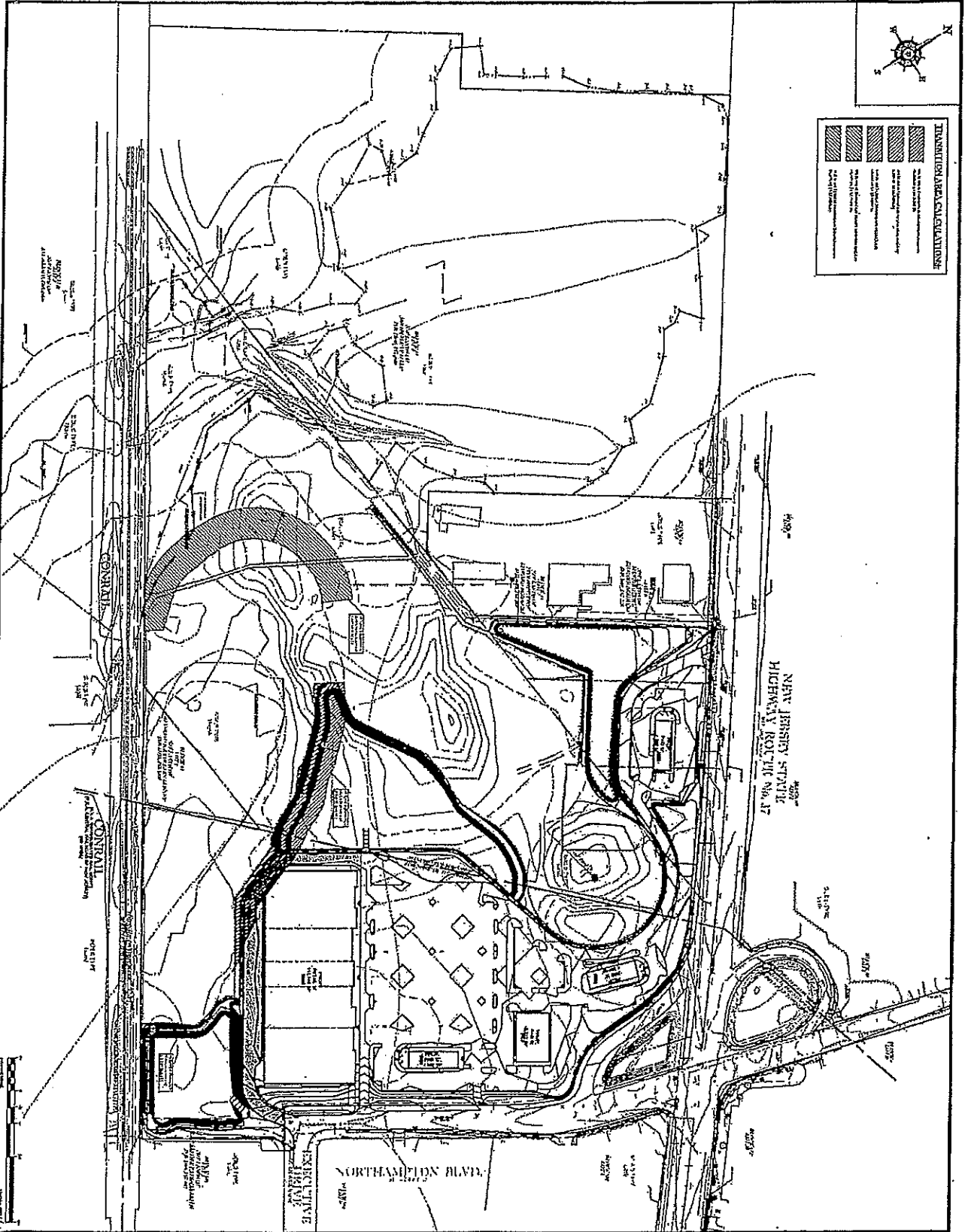

NEW JERSEY STATE
HIGHWAY ROUTE 99A

NORTHAMPTON BLVD.

<p>BOHLER ENGINEERING</p>		<p>PROJECT NO. 100-100-100</p> <p>SHEET NO. 100-100-100</p>	
<p>PREPARED BY: [Name]</p> <p>CHECKED BY: [Name]</p> <p>DATE: [Date]</p>		<p>APPROVED BY: [Name]</p> <p>DATE: [Date]</p>	
<p>PROJECT LOCATION: [Address]</p> <p>CLIENT: [Name]</p>		<p>SCALE: [Scale]</p> <p>DATE: [Date]</p>	

CONRAIL

CONRAIL

INSPECTIVE

INSPECTIVE

PHILIP J. [Name]

PHILIP J. [Name]

PHILIP J. [Name]

PHILIP J. [Name]

PHILIP J. [Name]

PHILIP J. [Name]

PHILIP J. [Name]

PHILIP J. [Name]

PHILIP J. [Name]

PHILIP J. [Name]



REVISIONS	
NO.	DESCRIPTION
1	ISSUED FOR PERMITS
2	ISSUED FOR CONSTRUCTION
3	ISSUED FOR AS-BUILT
4	ISSUED FOR RECORD
5	ISSUED FOR FINAL
6	ISSUED FOR FINAL
7	ISSUED FOR FINAL
8	ISSUED FOR FINAL
9	ISSUED FOR FINAL
10	ISSUED FOR FINAL

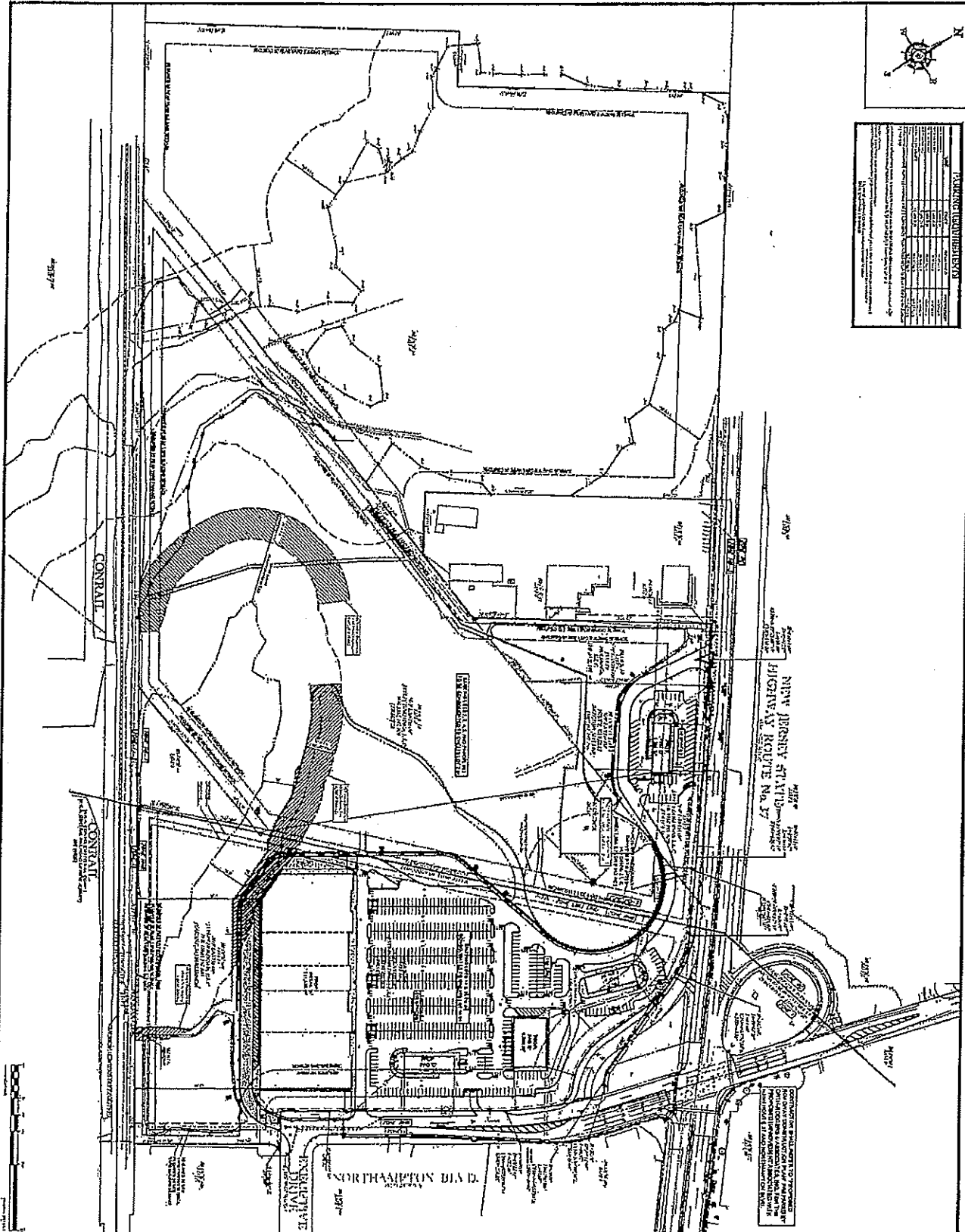

BOHLER ENGINEERS 1000	PHILIPPI & PHILIPPI	GRUNIN PROPERTIES	DE WISOTSKY	OVERALL PLAN C-03
				

GENOVA BURNS LLC - ATTORNEY BUSINESS ACCOUNT

The Township of Toms River

58977

DATE	INVOICE NUMBER	MEMO	BALANCE
12/05/2017	12052017	CAFRA Storage Filing fee	50.00
CHECK DATE 12/05/2017	CHECK NUMBER 000058977		TOTAL 50.00

58977

GENOVA BURNS LLC
ATTORNEY BUSINESS ACCOUNT
494 BROAD STREET
NEWARK, NEW JERSEY 07102

VALLEY NATIONAL BANK

55-138/212

PAY: *Fifty and 00/100 Dollars*

NUMBER
000058977

DATE
12/05/2017

AMOUNT
*****50.00

TO THE
ORDER
OF
The Township of Toms River

⑈058977⑈ ⑆021201383⑆ ⑆001001663⑈

Details on back. Security Features Included.



1 OF 1

1 LBS

ROCHELLE WILSON
973-533-0777
GENOVA BURNS LLC
494 BROAD STREET
NEWARK NJ 07102

SHIP TO:

ALISON CARLISLE, TOWNSHIP CLERK
555-555-5555
TOWNSHIP OF TOMS RIVER
33 WASHINGTON STREET
TOMS RIVER NJ 08754

NJ 087 1-05

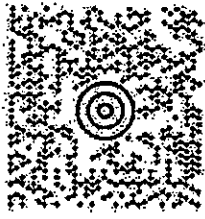

UPS GROUND

TRACKING #: 1Z A9R 389 03 9397 5779

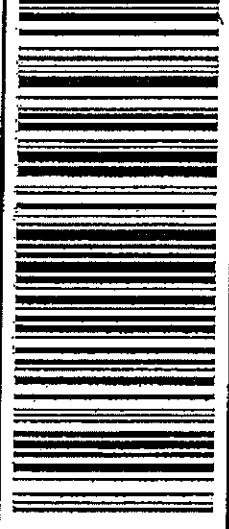

BILLING: P/P



Tkx Ref No.: 21886.004 (WFH)
Tkx Ref No.: Shipment Reference #2
303-18-01-35
973-533-0777



THE SHIPPING COMPANY THAT WORKS FOR YOU®

Please fold or cut in half

Print at 100% size and do NOT photocopy. Using a photocopy could delay the delivery of your package and may result in additional shipping charge.



Thank you for shipping with Unishippers.
UPS standard terms and conditions apply.

Rate Estimate: 8.04 USD
Protection: 0.00 USD

Weight (lbs): 1
Dimensions: 0x0x0
Ship Ref: 21886.004 (WFH)
Service Level: UPS Ground
Special Svc:

Shipment Date: 2018-01-25
Bill Shipment To: Bill My Account
Bill To Acct: A9R389

Description:

RECEIPT

Waybill #: 1ZA9R3890393975779
To (Company):

TOWNSHIP OF TOMS RIVER

33 WASHINGTON STREET

TOMS RIVER, NJ, 08754
UNITED STATES

Attention To:

ALISON CARLISLE, TOWNSHIP
555-555-5555

Sent By:

Rochelle Wilson
973-533-0777

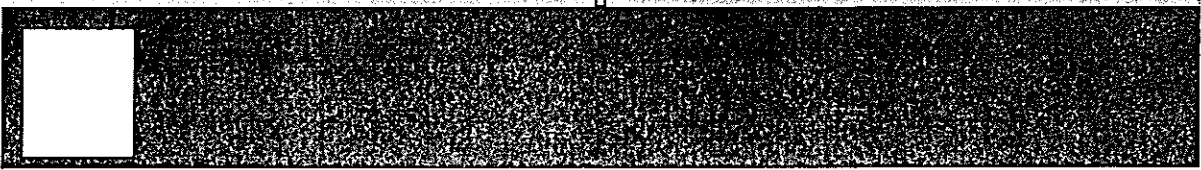

Your package has been delivered.

Delivery Date: Friday, 01/26/2018

Delivery Time: 10:56 AM

At the request of Genova Burns LLC this notice alerts you that the status of the shipment listed below has changed.

Shipment Detail

Tracking Number:	<u>1ZA9R3890393975779</u>
Ship To:	Alison Carlisle, Township Clerk Township of Toms River 33 WASHINGTON ST TOMS RIVER, NJ 08754 US
UPS Service:	UPS GROUND
Number of Packages:	1
Weight:	1.0 LBS
Delivery Location:	INSIDE DELIVERY KNEMOLLAR
Transaction Reference Number:	21886.004 (WFH)
Transaction Reference Number:	Shipment Reference #2



Manchester Township
Clerk's Office
January 25, 2018
Page 2

- *Boundary & Wetland Location Survey*, prepared by Control Point Associates, Inc., dated August 6, 2015, last revised November 20, 2017;
- *ALTA/ASCM Land Title Survey*, prepared by Control Point Associates, Inc., dated April 21, 2004, last revised November 29, 2017;
- *Preliminary & Final Site Plan for Grunin Properties*, dated November 30, 2017; and,
- Compact Disc containing the contents of the previous submission, Permit No. 1500-04-001.1, APL080001, SWW090001.

A brief description of the proposed development follows:

The proposed development includes one (1) 111,186-SF retail building, three (3) 4,800-SF restaurants and one (1) 9,322-SF retail building. Also included is the associated parking, circulation, utilities, stormwater management, landscaping and lighting associated with these uses. Five hundred and sixty-seven (567) parking spaces are proposed for the entire development. A stormwater management system that utilizes three above-ground basins has been designed to accommodate the development.

The Department of Environmental Protection welcomes comments and any information that you may provide concerning the proposed development and site. Please submit your written comments within 15 calendar days of receiving this letter to:

New Jersey Department of Environmental Protection
Division of Land Use Regulation
P.O. Box 420 , Code 501-02A
Trenton, New Jersey 08625
Attn: Toms River Bureau Chief or
Manchester Bureau Chief

If you have any questions regarding this notice, please feel free to contact me.

Very truly yours,

GENOVA BURNS LLC

1 LBS 1 OF 1

ROCHELLE WILSON
973-533-0777
GENOVA BURNS LLC
494 BROAD STREET
NEWARK NJ 07102

SHIP TO:
CLERK'S OFFICE
555-555-5555
MANCHESTER TOWNSHIP CLERK
1 COLONIAL DRIVE
MANCHESTER NJ 08759

NJ 087 1-02

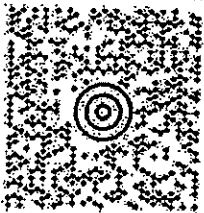

UPS GROUND
TRACKING #: 1Z A9R 389 03 9155 4389



BILLING: P/P

Text Ref No.: 21886.004 (WFH)
Text Ref No.: Shipment Reference #2
X0514.01.35 NPS 99 04 07 2018



Please fold or cut in half

Print at 100% size and do NOT photocopy. Using a photocopy could delay the delivery of your package and may result in additional shipping charge.



Thank you for shipping with Unishippers.

UPS standard terms and conditions apply.

Rate Estimate: 8.04 USD
Protection: 0.00 USD

Weight (lbs): 1
Dimensions: 0x0x0
Shp Ref: 21886.004 (WFH)
Service Level: UPS Ground
Special Svc:

Shipment Date: 2018-01-25
Bill Shipment To: Bill My Account
Bill To Acct: A9R389

Description:

RECEIPT

Waybill #: 1ZA9R3890391554389

To (Company):

MANCHESTER TOWNSHIP

1 COLONIAL DRIVE

MANCHESTER, NJ, 08759

UNITED STATES

Attention To:

CLERK'S OFFICE

555-555-5555

Sent By:

Rochelle Wilson

973-533-0777

